



Accesorios de presión encolar & mixtos PVC-U

Manguito unión mixto ITEM 014

| Ref. | Descripción | P.Neta | Vol. (m ³) | P.Bruta | Lote |
|---------|--------------------------------|--------|------------------------|---------|------|
| 1002010 | MANGUITO UNION MIXTO 20-1/2" | 0.016 | 0.00473 | 1.71 | 100 |
| 1002011 | MANGUITO UNION MIXTO 25-3/4" | 0.023 | 0.00892 | 2.45 | 100 |
| 1002012 | MANGUITO UNION MIXTO 32-1" | 0.039 | 0.00892 | 2.92 | 70 |
| 1002013 | MANGUITO UNION MIXTO 40-1 1/4" | 0.068 | 0.02244 | 5.60 | 75 |
| 1002014 | MANGUITO UNION MIXTO 50-1 1/2" | 0.095 | 0.03682 | 10.06 | 100 |
| 1002015 | MANGUITO UNION MIXTO 63-2" | 0.164 | 0.04717 | 12.98 | 75 |
| 1002016 | MANGUITO UNION MIXTO 75-2 1/2" | 0.223 | 0.04717 | 11.34 | 48 |
| 1002017 | MANGUITO UNION MIXTO 90-3" | 0.410 | 0.03682 | 10.39 | 24 |
| 1002018 | MANGUITO UNION MIXTO 110-4" | 0.562 | 0.04460 | 9.72 | 16 |



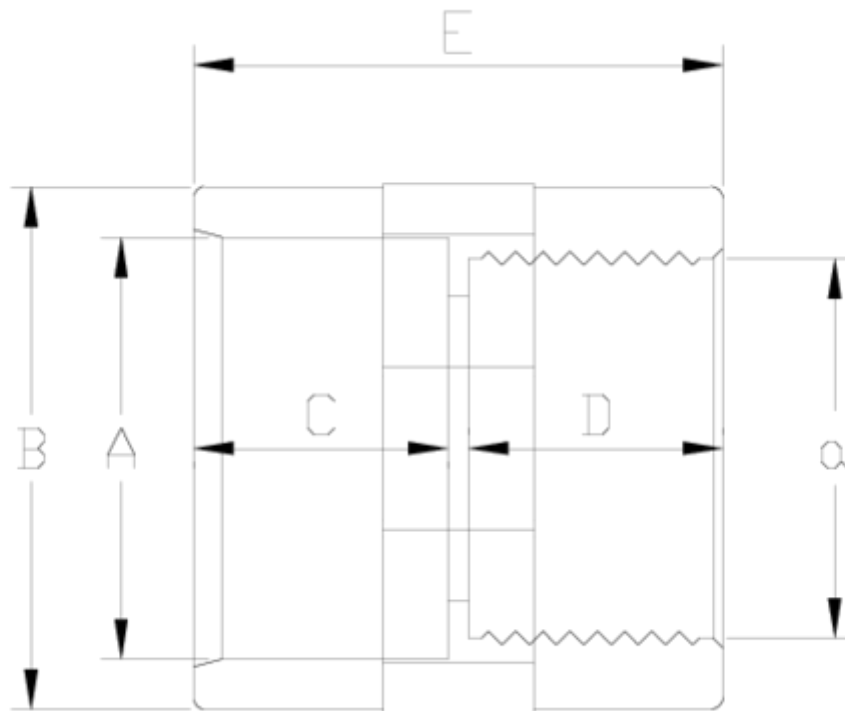

ITEM 014 | Manguito unión mixto

| Código | A-a | Peso (g) | B | C | D | E | PN | ROSCA |
|--------|-----------|----------|-----|----|----|-----|------|-------|
| 02010 | 20-1/2" | 16 | 28 | 17 | 16 | 36 | PN10 | BSP |
| 02011 | 25-3/4" | 24 | 34 | 20 | 17 | 41 | PN10 | BSP |
| 02012 | 32-1" | 40 | 42 | 22 | 21 | 48 | PN10 | BSP |
| 02013 | 40-1 1/4" | 66 | 51 | 27 | 23 | 53 | PN10 | BSP |
| 02014 | 50-1 1/2" | 100 | 61 | 32 | 24 | 61 | PN10 | BSP |
| 02015 | 63-2" | 153 | 75 | 39 | 28 | 72 | PN10 | BSP |
| 02016 | 75-2 1/2" | 270 | 90 | 44 | 32 | 85 | PN10 | BSP |
| 02017 | 90-3" | 457 | 110 | 51 | 35 | 100 | PN10 | BSP |
| 02018 | 110-4" | 615 | 129 | 61 | 39 | 108 | PN10 | BSP |



DOCUMENTACIÓN DE PRODUCTO



FAMILIA
TÉCNICA

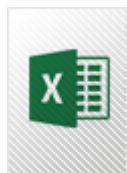

CERTIFICADOS DE PRODUCTO

CERTIFICADOS DE EMPRESA



Pol. Ind. Plá Vallonga,
c/ Agua, 28
03006 ALICANTE (España)



+34 965 11 42 82



+34 965 11 48 62



tecnicocomercial@hidroten.es



Servicio Atención
Técnica comercial
+ 34 966 105 888



www.hidroten.es